



MARK 4 GS AL

MARK 6 GS AL

MARK 4 GS CF

MARK 6 GS CF

# User Guide

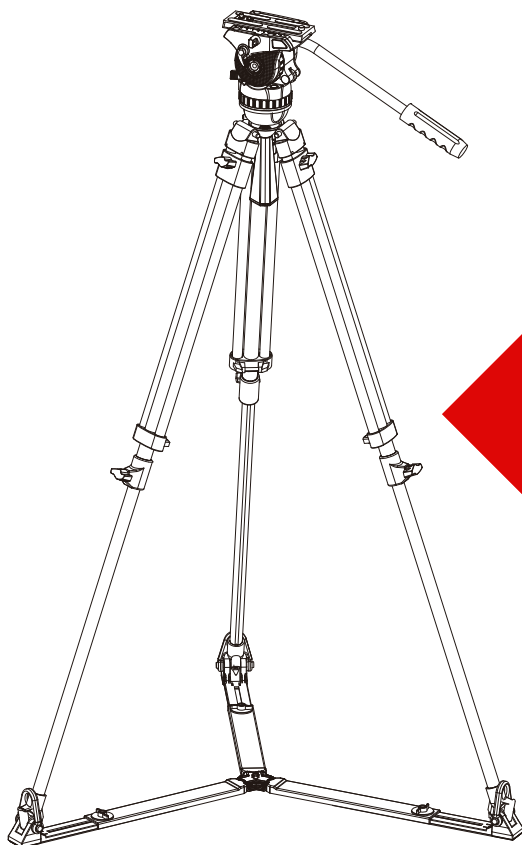

**Copyright © 2017**

All right reserved throughout the world.

No part of this document may be stored in a retrieval system, transmitted, copied or reproduced in any way including, but not limited to, photocopy, photograph, magnetic or other record without the prior agreement and permission in writing of Camgear Inc.

### **Disclaimer**

The information contained in this publication is believed to be correct at the time of printing.

Camgear Inc. reserves the right to make changes to the information or specifications without obligation to notify any person of such revision or changes.

Changes will be incorporated in new versions of the publication.

Camgear reserves the right to make changes to product design and functionality without notification.



are registered trademarks of Camgear Inc.

**Published by**

Camgear Inc.

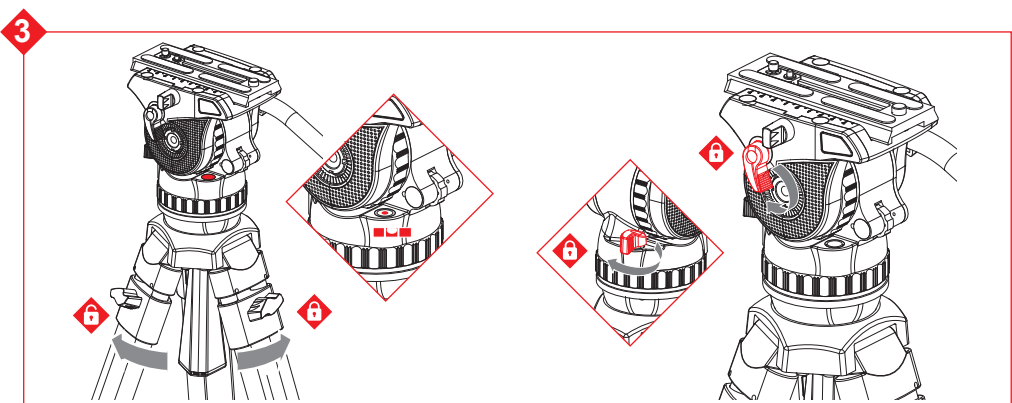
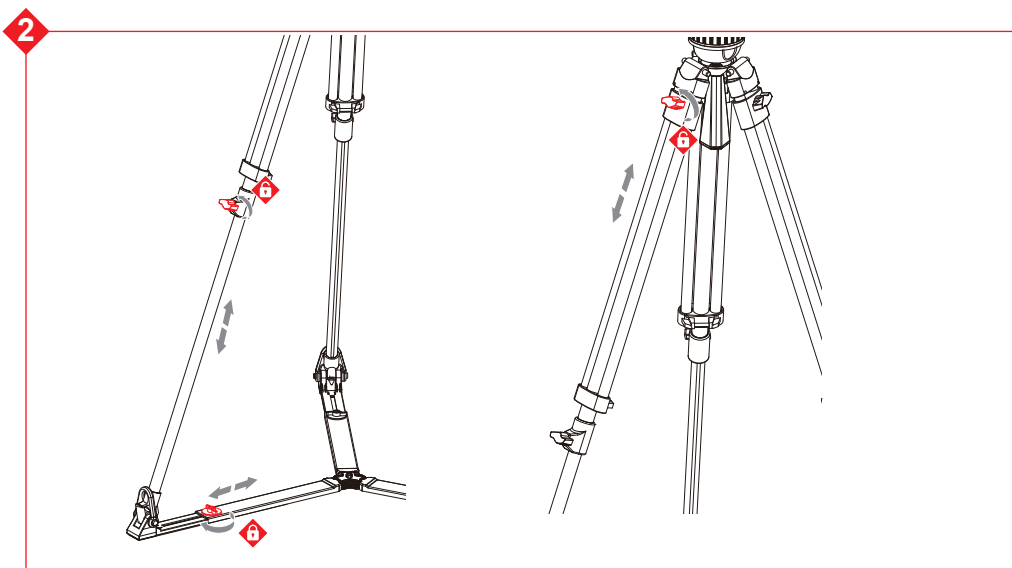
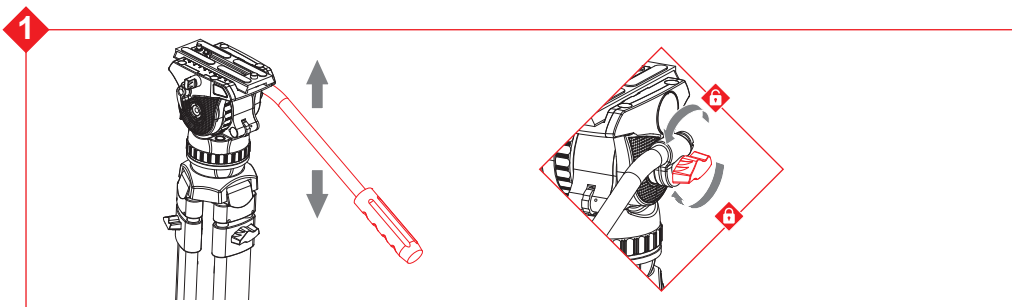

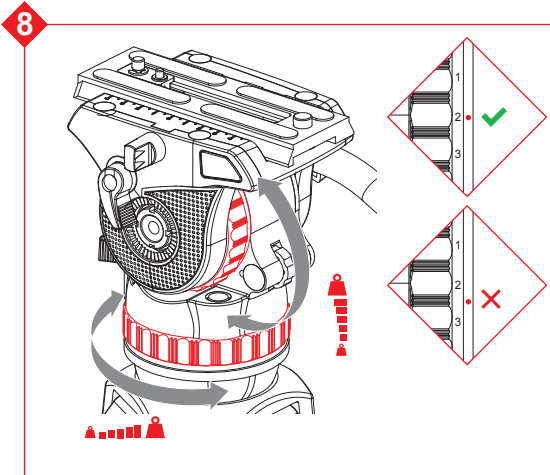
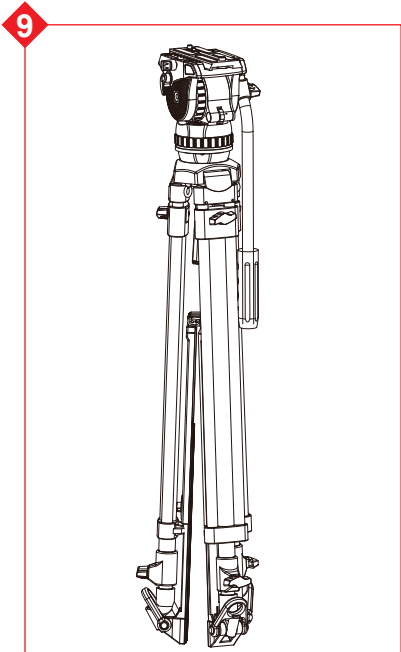
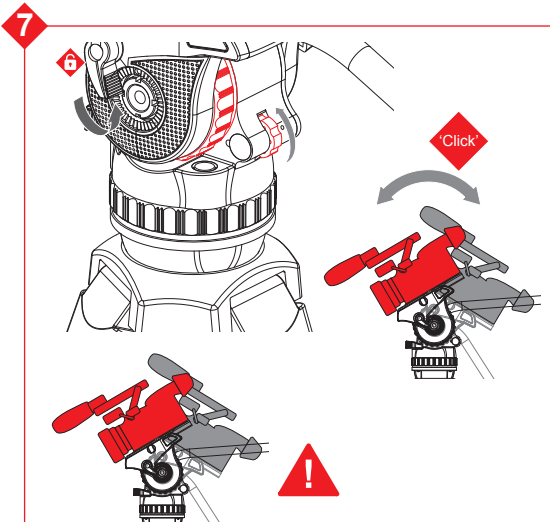
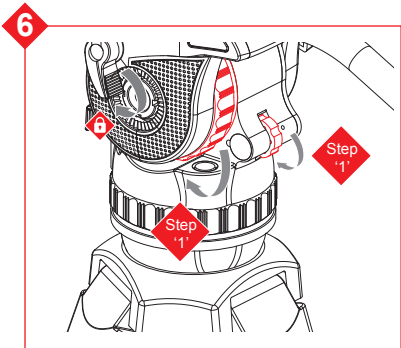
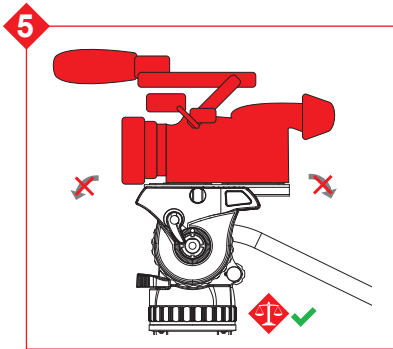
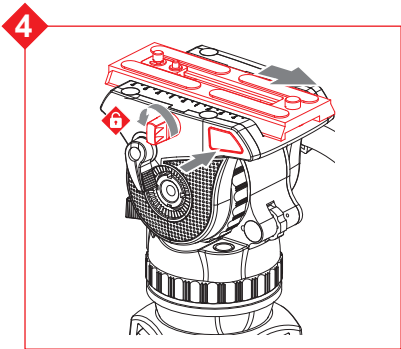

## TRIPOD SETUP

Adjust the pan bar position. Loosen the pan bar clamp and adjust the angle of the pan bar handle. Tighten the pan bar clamp.

Open the tripod.

Hold the fluid head with one hand, Loosen the tripod lower stage leg locks and extend the legs to the required height. Tighten the leg locks.

Set the tripod footprint to suit the shooting environment. Loosen the spreader locks and adjust to the required length. Tighten the spreader clamps.

Loosen the tripod upper stage leg locks and extend the leg to the required height. Tighten the leg locks.

**NOTE:** In windy conditions, attach a weight (max. 10 kg/22 lbs) to the tripod tie down to stabilise the tripod.

## FLUID HEAD STEUP

### Leveling

Loosen the bowl clamp. Level the fluid head using the level bubble. Tighten the bowl clamp.

### Mounting the camera

Lock the tilt and pan brakes.

Loosen the slide plate clamping screw. Pull the slide plate to the rear of the fluid head whilst pressing the red release button.

Attach the slide plate to the camera using the camera screws and pin supplied.

Hold the camera with one hand. Insert the slide plate onto the rear of the platform. Slide forward until the locking button secures the slide plate onto the platform.

Position the camera C of G over the axis of the fluid head. Tighten the clamping screw to secure the camera.

## Setting counterbalance

**CAUTION!** Hold the pan bar to prevent the camera from falling away.

Lock the tilt brake. Set the tilt drag and counterbalance to 1.

Open the tilt brake. Holding the pan bar, adjust the counterbalance setting until the camera remains in position hands-free. The 1 counterbalance setting is immediately effective when selected. When selecting the counterbalance settings 2-6 (MARK4 Head) or setting 2-8 (MARK6 Head), tilt the fluid head forwards and backwards through the horizontal position to engage the spring.

**NOTE:** If the camera does not remain in position hands-free, lock the tilt brake and adjust the position of the camera. If the camera falls forward, reposition the camera to the rear of the head. If the camera falls backward, reposition the camera to front of the head.

### Setting Drag

The fluid head has 3 drag levels horizontally and vertically. Drag is turn off when the 1 setting is selected. Rotate the drag ring to the required setting, then slowly move the fluid head vertically or horizontally to engage the spring. Open the brakes and check the amount of drag by slowly moving the head horizontally or vertically.

### Brakes

To prevent the fluid head from moving, lock the tilt and pan brakes. Do not use the brakes to apply drag.

## REMOVING THE CAMERA

Lock the brakes. Loosen the slide plate clamping screw. Press the slide plate release button whilst sliding the camera to the rear of the head.

## TRANSPORTING AND STORING

To ensure smooth and reliable operation over the long life of the fluid head, open the tilt and pan brakes and set the counterbalance and drag settings to maximum. Stow the attached pan bar in the vertical position with the tripod legs to prevent damage.